



PROSPECTUS SY 2024–2025

珠海德威招生简章



Address: NO. 29 Hong Jing Road, Heng Qin New Area, Zhuhai, China 519031

地址：中国广东省横琴粤澳深度合作区红景道29号 邮编：519031

座机/手机：(0756) 8693 233 / 18923392863, 18923361453

<http://zhuhai-high-school.dulwich.org>



微信公众号

Content
目录



CONTENTS
目录

| | |
|--|----|
| Welcome from Head of School 校长致辞 | 01 |
| About DHZH 关于德威 | 03 |
| Mission, Vision and Values 理念、愿景与价值观 | 05 |
| Our Teachers 师资力量 | 08 |
| Course Curriculum 课程体系 | 09 |
| IGCSE and A-Level Curriculum Guide 课程学习指南 | 11 |
| Accreditation and Awards 国际认证 | 12 |
| Co-curricular Activities (CCAs) 联课活动 | 16 |
| Worldwise Events 智胜全球活动 | 19 |
| Learning and Pastoral 学习与德育关怀 | 21 |
| Campus Facilities 校园环境 | 22 |
| Academic Performance and University Pathways 学术成就及升学路径 | 23 |
| Worldwise Alumni Network (WAN) 全球校友资源平台 | 27 |
| Admissions 入学申请 | 29 |
| School Site and Map 校址及地图 | 31 |

WELCOME FROM HEAD OF SCHOOL

I am delighted to welcome you to Dulwich Zhuhai, a prestigious international high school that prepares students for success in their IGCSE and A-Level examinations, and for admission to top universities around the world.

At Dulwich Zhuhai, we believe that education is not just about getting good grades, but about developing the whole person. We take a holistic approach to learning, nurturing our students' intellectual curiosity, creativity, social and emotional wellbeing, and sense of global citizenship competencies.

"Students come first" is a key pillar of the Dulwich family of schools. At Dulwich Zhuhai we provide a holistic approach to education. Our students are exposed not only to a rigorous programme of academics but also a range of bespoke learning experiences allowing them to explore and discover their interests and talents beyond the curriculum, from music and theatrical performances to exhibitions and engineering.

Our team of highly dedicated teachers, staff, and fellow parents are committed to providing your child with a stimulating and supportive learning environment, and reach their full potential. We believe in creating a community of lifelong learners, where everyone has the opportunity to explore their passions, develop their talents, and make meaningful connections with others.

Our extensive extra-curricular programme offers a wide range of activities, from music and drama to sports and community service. We encourage our students to step out of their comfort zone, take risks, and discover new interests and talents. Our teachers are experts in their fields, with a deep commitment to excellence, innovation, and continuous improvement.

We are proud to be part of the Dulwich family of schools, which has a long-standing reputation for academic excellence, innovation, and social responsibility. Our international community share a common vision of creating a better world through education, and we are committed to working together towards this goal.

I invite you to visit our beautiful campus in Zhuhai, where you will experience our warm and welcoming community, in state-of-the-art facilities. Meet our teachers and students, and learn more about the Dulwich approach to education, which has inspired generations of young people to achieve their dreams.

Head of School
Clare Hooper: 

校长致辞

欢迎来到珠海德威。在这里，学生通过学习IGCSE和A-level课程，为未来进入世界顶尖的大学做好准备。

在珠海德威，我们相信教育不应仅仅是追求卓越的学术成绩，更是收获个人的全面发展。秉承全人教育理念，珠海德威关注学生的求知欲、创造力、身心健康以及全球胜任力的培养。

“以学生为先的全人教育”是珠海德威和其德威大家庭所有姐妹学校的重要支柱。我们的课程体系严谨，学科兼顾广度和深度，从音乐到戏剧表演，从各领域的学术展览再到工程学科的深入研习，学生会通过一系列的学习体验来探索和发现个人独特的兴趣和才能。

我们的教学团队由高素质的老师组成，他们对教学充满热情。校内员工和家长也是学生茁壮成长的强力后盾。我们致力于构筑一个终生学习者的社区，通过创造丰富的机会让每个学生充分探索自己的兴趣和才能，同时对身边的人和社区产生积极影响。

我们的联课活动提供丰富的课外体验，包括音乐、戏剧、体育和社区服务等领域。我们鼓励学生踏出舒适区，敢于冒险，发掘个人的优势和热爱所在。我们的教师在各自领域均有着丰富的经验，并承诺通过优质的教学活动和开拓创新的精神，持续支持学生的个人进步。

德威大家庭足迹遍布全球，在学术、创新和社会责任等领域享有盛名。作为德威大家庭的一员，珠海德威与集团有着同样的教育愿景，即通过教育创造更美好的世界。

诚邀您莅临珠海，在我们美丽的现代化校园里近距离体验珠海德威的教学和校园生活，并在与师生的亲切交流中感受本地社区大家庭的温暖。期待与您携手，助力学生们圆梦理想，睿引未来。

校长: 

About DHZH

关于德威

Dulwich International High School Zhuhai (Dulwich Zhuhai) was co-founded by Education in Motion (EiM) and Zhuhai Huafa Industry Investment Holdings Co., Ltd in 2010. The unparalleled educational resources and local brand advantage provide DHZH students with a wealth of opportunities to develop their interests and broaden their perspectives.

Dulwich International High School is part of the wider EiM family. Education in Motion (EiM) aspires to be the global leader in pioneering education for a sustainable future, inspiring general ons of learners to Live Worldwise. Its diverse portfolio is united by a strong common commitment to innovative education that nurtures students who can make a positive impact for people and the planet. EiM scales learnings, opportunities and resources across its diverse family, enabling each of its brands to be at the cutting-edge. Today, EiM's portfolio includes Dulwich College International, Dulwich International High School, Dehong , Green School International, Hochalpinies Institut Ftan AG, Wo Hui Mandarin, and EiM Ventures; together, they are inspiring a learning community more than 11,000-strong.

Dulwich Zhuhai offers students comprehensive academic support, university and career counselling, an immersive linguistic environment, and a global culture to graduate worldwise. Our students are provided with a supportive environment of mutual care, respect, and concern from all staff members. We believe our students must gain a holistic experiences and skills to engage effectively with new opportunities, thrive in a changing future, and create real impact as global citizens.

珠海德威国际课程高中项目（以下简称为“珠海德威”）于 2010 年由屹珈（EiM）国际教育集团与珠海华发教育产业投资控股有限公司共同创办。华发立足本地的品牌及强强联合的教育资源优势为珠海德威学生带来了多方位的机会，帮助他们拓宽视野和发展兴趣。

德威国际高中项目是EiM大家庭的一份子。为构筑可持续发展的未来，屹珈(EiM)国际教育集团立志成为开创性教育的全球领军者，激励一代又一代的学生心怀世界，睿引未来。其多元的品牌组合被一个坚定的共同承诺所凝聚，即通过开创性教育培养能够对人类和地球产生积极影响的学生。EiM在其多元化的品牌大家庭中扩展学习、机会以及资源，确保每个品牌都处于行业前治。如今EiM的牌组合包括德威国际学校、德威英国高中项目、Sherfield School、德阔、Green School international、Hochalpinies Institut Ftan AG、Ignite和我会中文；他们共同激励着一个超过11,000人的学习社区。

珠海德威为学生提供广泛均衡且高质严谨的课程、国际化的语言环境和文化氛围，以及全方位的升学和职业规划指导，细致地陪护学生的身心健康，助力发展个性化的成长路径，从而帮助学生进入最匹配个人特质和发展的海外高校。未来，无论他们身处于世界的哪一个国度，都取得学业和生活的成功。



Mission, Vision and Values

理念、愿景与价值观

We prepare our students to thrive and make a positive difference anywhere in the world. We are a bridge connecting students with the world. We provide personalized, student-centered pathways and a broad-based curriculum that is embedded with sustainability, service and global citizenship.

"Students Come First"

Our learning experiences are designed with a focus on student needs, capabilities and wellbeing. We encourage our students to cultivate their voice and choice in their learning journey.

It is our goal to ensure that every student that walks through the doors of our school not only gains access to their first choice of university, but is also thoroughly prepared to thrive and succeed at university and beyond.

我们的学生“心怀世界，智胜全球”。我们致力于 为学生架构通往世界的桥梁。为此，珠海德威为学生定制个性化的、以学生为中心的发展路径，提供 广泛的课程，并将可持续发展、服务意识、以及全球胜任力融入其中。

学生为先

珠海德威所有学习环境和体验都是以学生的需求、天赋、才能以及身心健康为重点以及出发点。我们着力于了解学生的个性，并鼓励他们在学习旅程中能够多发声，并作出自己的选择。

我们的目标是让每一位从珠海德威毕业的学生不仅能够入读他们的最佳适配大学，更能在最适合他们发展的领域上大放异彩。

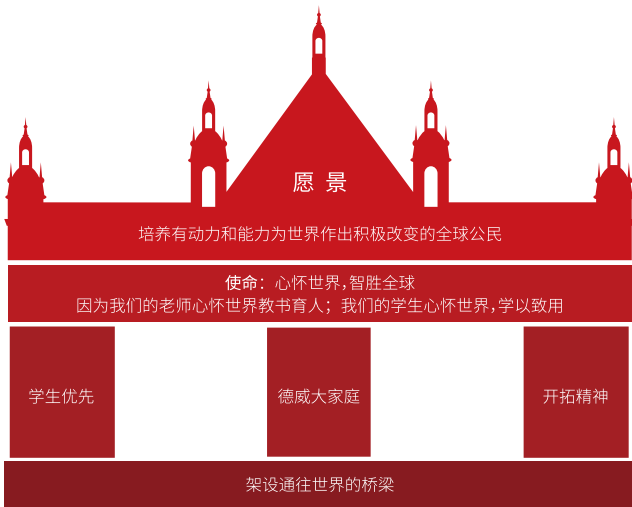

OUR VALUES

价值观

✿ EXCELLENCE 卓越

✿ RESPECT 尊重

✿ INTEGRITY 正直

✿ CELEBRATION 颂扬

✿ LEADERSHIP 引领

✿ DETERMINATION 信念

✿ COMMUNITY 奉献

✿ ADAPTABILITY 应变





Our Teachers 师资力量



Our highly dedicated teachers are selected through a rigorous screening process and are recruited globally with the Group's full support. They are all accredited Postgraduate Certificates in Education (PGCE) or hold equivalent international teaching license from the UK, North America and Australia. About 80% of our teachers are native English Speakers who have taught in their native countries and have a thorough knowledge of the IGCSE and A-Level curriculum.

珠海德威的外籍教师在屹珈（EiM）国际教育集团的全方位支持下，经过严格筛选，层层把关，在全球招聘中脱颖而出。珠海德威所有教师均持有经国际权威认证的研究生教师教育证书。超过80%的德威教师母语为英语，并在其国籍所在国家担任过中学教师，对IGCSE 和A-Level 课程有着深刻的了解。

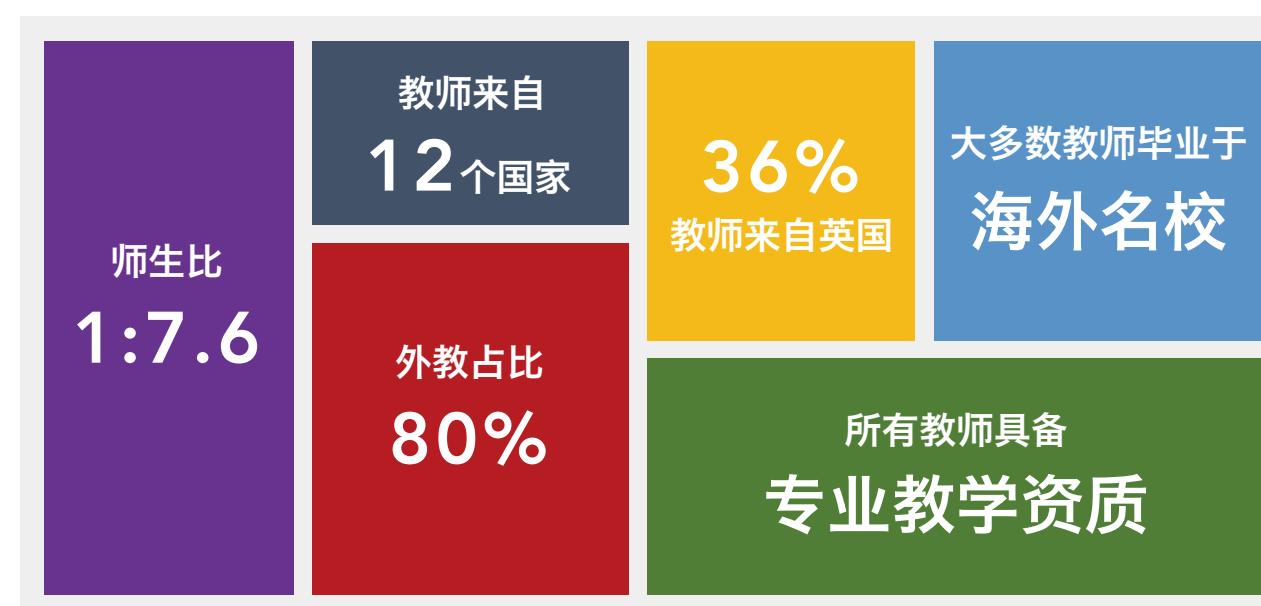

Course Curriculum

课程体系

Our curriculum is thorough with a breadth and depth of subjects ranging from Science, Music, Drama and Performance, from learning in the classes, project task to academic presentations. Through a variety of learning experiences, students can explore and discover their interests and talents. A wide range of courses give the students more career options for further study.

我们的课程体系严谨，学科兼顾广度和深度，从科学到人文，艺术到计算机，音乐到戏剧表演，以及从各领域的课题研究再到学术演讲，学生能通过一系列的学习体验来探索和找到个人独特的兴趣和才能。丰富的课程为升学的专业选择提供更多机会。



IGCSE

Year 10

- Adapt to the new curricular and school life
- Build a good foundation
- Identify your advantage
- 适应新环境
- 打好基础
- 明确兴趣

Year 11

- Participate in different CCAs
- Research on universities
- IGCSE exams
- 尝试新活动
- 了解大学
- IGCSE考试

Compulsory 必修

Mathematics, English, Chinese
数学、英语、中文

Optional 选修(选五门)

Science:
Physics, Chemistry, Biology
(at least choose one out of three)

General:
Business Studies, Economics, EAL, PE, Computer Science, Environmental Management, Art, Drama, Music

科学:
物理、化学、生物
(至少三选一作为考试科目)

综合:
商科、经济、英语支持、体育、计算机科学、环境管理、艺术、戏剧、音乐

A Level

Year 12

- Start AS study
- Review school transcript
- Plan for your university and career
- 开始AS学习
- 回顾成绩单
- 职业规划

Year 13

- Start A2 study
- One-to-one university counselling
- Submit university applications
- 进入A2学习
- 成绩冲刺
- 完成大学申请

Optional 选修(选三至四门)

Chinese, Mathematics, Further Mathematics, Physics, Chemistry, Biology, Geography, History, Music, Economics, Business Studies, Art and Design, Drama, Computer Science

中文、数学、高等数学、物理、化学、生物、地理、历史、音乐、经济、商科、艺术与设计、戏剧、计算机科学

Additional 附加课程

Extended Project Qualification, PE, University Counselling
拓展研究项目证书、体育、升学指导

University, 入读大学

- In addition, we also offers a fast-track programme of IGCSE for students who choose to focus on science subjects.
- 此外，珠海德威还为专注学习理科的学生提供只需一年 IGCSE 的快速课程。

IGCSE and A-Level Curriculum Guide 课程学习指南



IGCSE OPTIONS GUIDE
IGCSE 课程学习指南



THE A LEVEL CURRICULUM GUIDE
A LEVEL 课程学习指南



Accreditation and Awards 国际认证

Students at Dulwich Zhuhai study IGCSE and A Level curriculum. The school holds full accreditation by the Edexcel, the Cambridge International Examinations Assessment (CAIE), the Assessment and Qualifications Alliance (AQA), Middle States Association of Colleges and Schools Commissions on Elementary and Secondary Schools (MSA-CESS), Accreditation International (AI) and the National Council for Private School Accreditation (NCPSA). Dulwich Zhuhai students can apply to universities around the world, including Hong Kong, the UK, the US, and Canada.

For students interested in applying to universities in the US, transcripts from accredited international schools will be more competitive. For example, MSA CESS accreditation indicates that the school is recognised for its educational philosophy and vision, leadership, planning, instructional programs, assessment, student services, student life, student activities, information technology, finances, facilities, and health and safety.

珠海德威的 IGCSE 和 A Level 课程获得爱德思考试局、剑桥国际考试委员会、牛津 AQA 考试局、美国中部教育联盟 (MSA CESS)、认证国际和美国私立院校认证委员会认证。就读珠海德威的学生可申请入读香港、英国、美国、加拿大等全球各地的大学。

其中，对于有意向申请美国大学的学生来说，成绩单如果出自具有认证的国际学校将更具有竞争力。比如MSA CESS 的认证，说明了学校在教育理念和视野、领导力、规划、教学项目、评估、学生服务、学生生活、学生活动、信息资源和技术使用、财务、设施以及健康与安全等方面都得到了认可。





SCIENCE LAB SAFETY

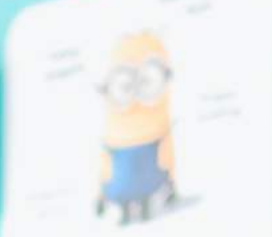

Use Protective Gear

- 1. Safety Goggles
- 2. Lab Coat
- 3. Protective Gloves
- 4. Lab Shoes

Clean Up

After completing the lab, carefully clean your workspace and the equipment. Don't forget to wash your hands.

Proper Supervision

Don't perform lab experiments without instructive supervision.



Co-curricular Activities (CCAs) 联课活动

Apart from exceptional academic achievements, Dulwich Zhuhai offers a wide range of Co-curricular Activities ('CCAs') in a variety of areas.

Students are expected to participate in at least two per week, after class in the Monday-to-Thursday afternoons. There are over 60 CCAs on offer a week, focusing on three areas: Sport and Leadership, MADD (Music, Art, Dance, Drama), and Academic Enrichment.

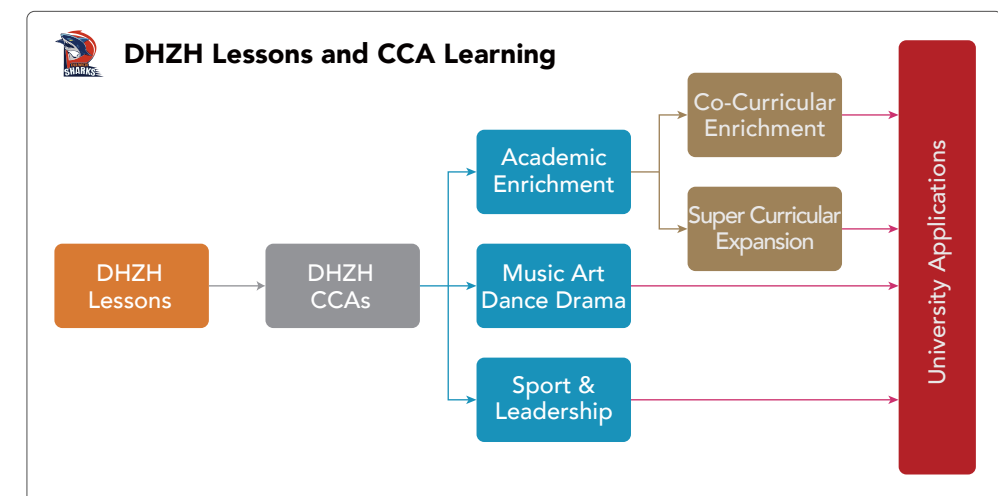

除了优秀的学术成绩以外，课外实践也是海外大学对学生考察的重要方面。珠海德威开展了囊括不同领域的丰富联课活动（Co-curricular Activities, “CCAs”）。

在学校每周的课程安排中，周一至周四下午均设有固定课外活动时间，学生每周需至少参加两项。联课活动的类型涵盖三个板块：体育和领导力、MADD（音乐、艺术、舞蹈、戏剧），以及学科课题研究，数量超过60项。

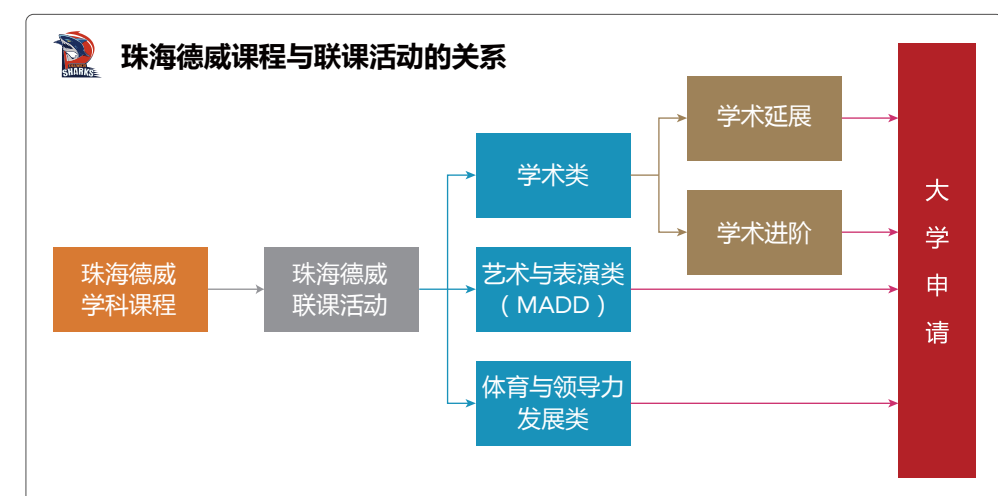

Co-curricular Activities (CCAs)

联课活动

Academic Enrichment

- International Chemistry Olympiad
- English Corner
- Mock United Nation
- World Scholar's Cup
- Microbit Programming using Python
- LAMDA Public Speaking
- Marine Studies
- TED-Ed Student Talks
- The DHZH Science Podcast
- Introduction to Psychology
- Chinese Traditional Culture etc.

MADD (Music, Art, Dance and Drama)

- Songwriting, recording and performing
- The School Musical
- The School Choir
- School Orchestra etc.

Sports and Leadership

- Duke of Edinburgh's International Award
- Badminton Club
- Boys and Girls Football Team Training
- Chess masters and Table Sports
- Fitness for health and wellbeing
- Rowing Club
- Golf
- Equestrian etc.

Student-led CCAs

- British Biology Olympiad
- AMC Studio
- Baking club
- Worldwide Finance Union
- Fashion Design and History
- Ultimate Frisbee
- Aeronautical Engineering & Aircraft Design etc.

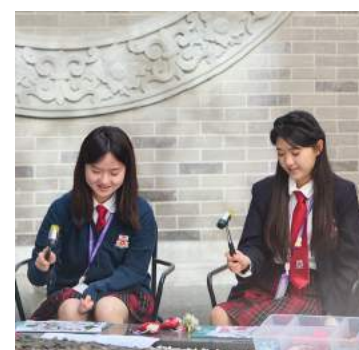

学术类

- 国际化学奥林匹克学习小组
- 英语角
- 模拟联合国 (MUN)
- 世界学者杯
- Python编程社
- LAMDA公开演讲营
- 海洋研究社
- TED演讲社
- 珠海德威科学播客
- 心理学概论
- 中国传统文化社等

艺术与表演类

- 作曲、录音及声乐表演小组
- 学校音乐剧
- 学校合唱团
- 学校管弦乐团等

体育和领导力发展类

- 爱丁堡公爵国际奖
- 羽毛球社
- 篮足球训练营
- 国际象棋和桌面竞技运动
- 瑜伽社
- 健身俱乐部
- 赛艇社
- 高尔夫球社
- 马术俱乐部等

学生创办的联课活动

- 生化实验小组
- 创意航拍俱乐部
- 飞盘
- 时尚史研究小组
- 美术与设计俱乐部
- 财经小组
- 烘焙社
- 航空科普小组等

Worldwise Events

智胜全球活动

The Worldwise Events programme was launched more than a decade ago, with the initial goal of providing students at Dulwich College International schools with opportunities to gather, rehearse and perform music. This led to the forming of now-iconic festivals such as the Dulwich Festival of Music, an annual music festival for Senior School students and ISCMS (the International Schools Choral Music Society), one of the biggest and most prestigious annual music festivals for international schools in Asia.

Since those first years, Worldwise Events have grown both in depth and breadth, adding several new elements to the annual programme such as the beloved MADD (Music, Art, Drama, Dance) Festival; the prestigious Shackleton Lectures inviting world renowned adventurers and explorers inspiring our communities; collaborating and producing performances with the Royal Shakespeare Company, sharing best practice; the Student Leadership Conference for future leaders; publishing a poetry anthology with British slam poet Mark Grist; or the famous Dulwich Olympiad hosted by a different school every 4 years where more than 600 students come together for a week of music, drama, arts, dance and sports activities in world famous locations such as the Queen Elizabeth Hall and the Olympic Park.

“智胜全球活动”推出至今已有十年以上，最初目标是给德威的学生提供一个聚在一起彩排和表演音乐节目的机会，后来逐渐形成了一批具有代表性的校际大联欢活动，例如一年一度的与英国皇家北方音乐学院合办的“德威音乐节”（Dulwich Music Festival），以及亚洲国际学校中规模最大、最负盛名的年度音乐盛会“国际学校合唱音乐节”（ISCMS）。

创办初期至今，“智胜全球活动”不断拓展内容深度和广度，每年的活动都会增添一些新元素，例如“MADD艺术节”（MADD）；“沙克尔顿讲座”（Shackleton Lectures），邀请世界知名冒险家和探险家为德威教育社区带来鼓舞人心的讲座；与皇家莎士比亚剧团（Royal Shakespeare Company）的老师合作排练节目；“学生领导力峰会”（Student Leadership Conference），重点培养中学部学生领袖；与英国大满贯诗人Mark Grist共同出版诗集；以及声名在外的“德威奥林匹克盛会”（Dulwich Olympiad），每四年由不同学校轮流举办，600多名德威学子齐聚一堂，前往世界各地的重量级场所（如伊丽莎白女王音乐厅和奥林匹克公园）参与为期一周的音乐、戏剧、艺术、舞蹈和运动盛事。

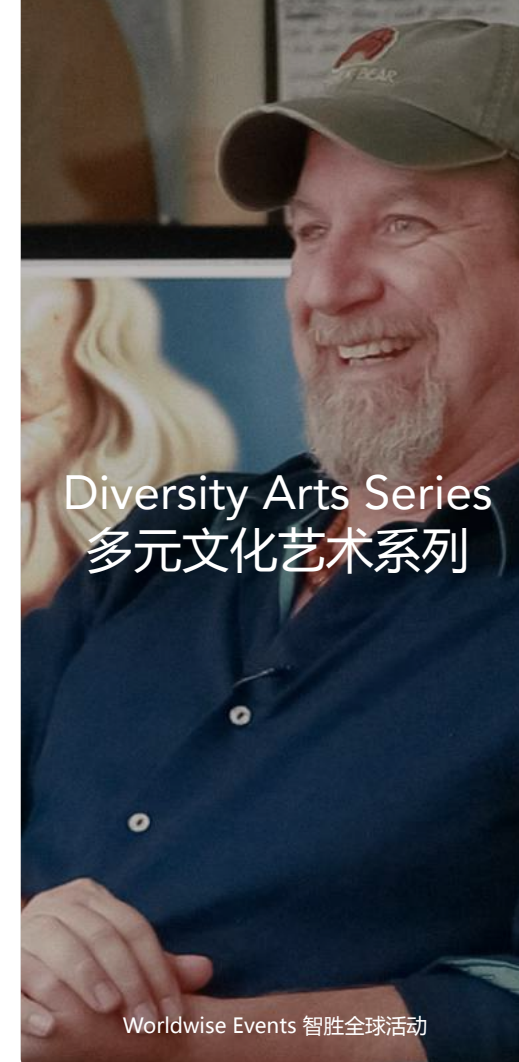

Learning and Pastoral 学习与德育关怀

With the immersive learning environment in Dulwich Zhuhai, students can smoothly adjust to the culture and linguistic environment of studying and living abroad. In addition to English coursework, the English language teaching team regularly organises English debates, speeches, reading challenges, creative writing competitions, and other activities to improve students' English proficiency in all areas so that they can become confident and comfortable speakers of English in the future.

Dulwich Zhuhai encourage students to take the initiative to explore and develop their independent learning and critical thinking skills to become independent lifelong learners. Through the combination of an international curriculum, a Western pedagogical approach to teaching and a highly developed pastoral system that combines the best of both East and West, our students are best placed to succeed overseas.

珠海德威为学生提供浸润式的学习氛围，以帮助学生提前适应国外学习和生活的语言环境。除了英文的教学授课，珠海德威会定期开展英语辩论、演讲、阅读挑战、英文写作比赛等活动，最大程度地帮助学生从听说读写各方面提高英语水平，使得他们即便未来处于全英语的环境中，也能成为自信、自如的英语使用者。

透过整合的国际课程体系、融合中西方优点的教学方式以及严谨的学生辅导体系，珠海德威鼓励学生主动探索，培养学生的自主学习能力和思辨能力，成为独立的终身学习者，有效帮助学生顺利应对在海外生活和学习的挑战。



Campus Facilities 校园环境

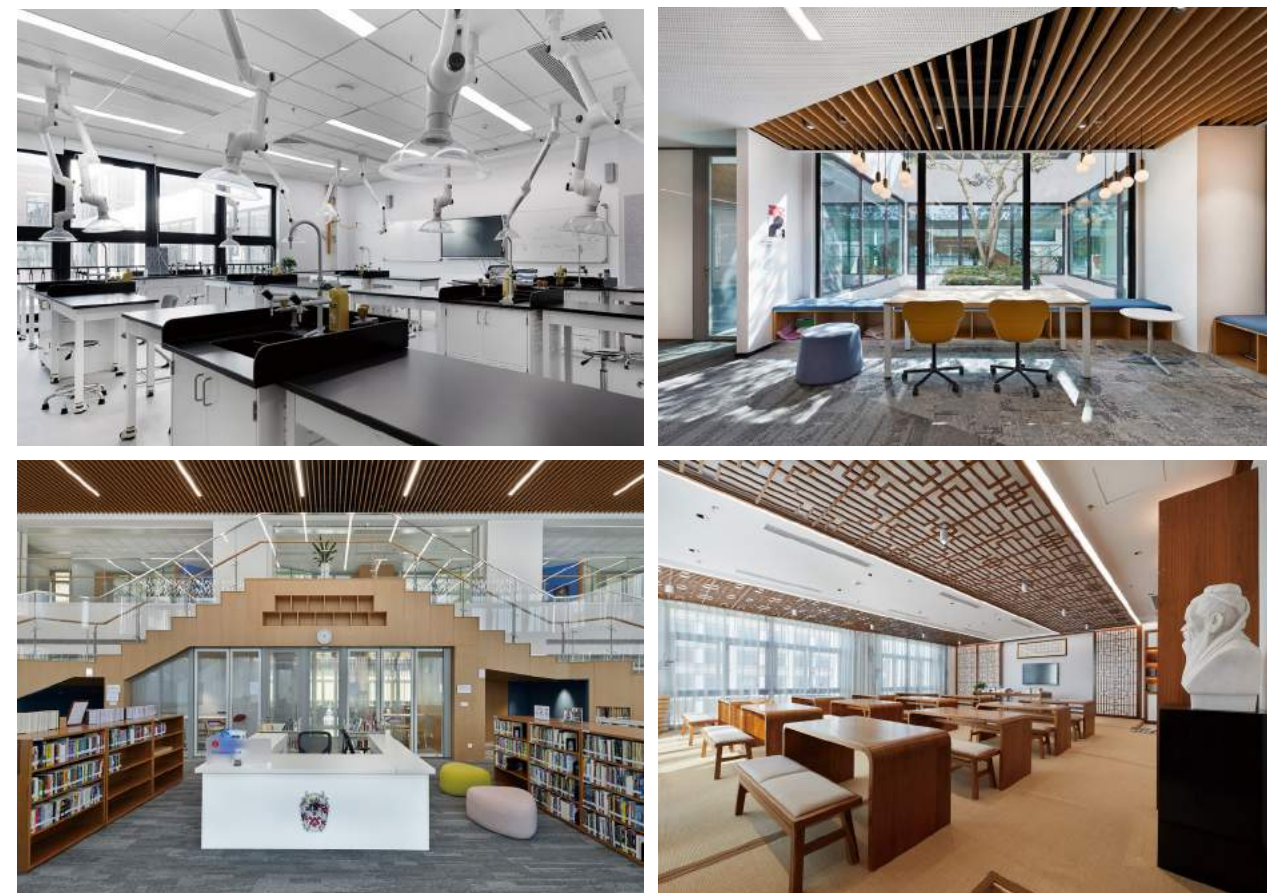

In line with 'Students Come First', Dulwich Zhuhai boasts a fully furnished campus with high quality facilities for teaching, events, and activities. Dulwich Zhuhai adopts an ecological architectural design strategy based on the concept of harmonious coexistence between human beings and nature, integrating natural elements throughout the campus. It has also been awarded LEED Gold certification. The campus occupies over 19,600 square metres and features 30 classrooms, 14 science laboratories, four outdoor sports halls, an indoor gymnasium, a 363-seat theatre, an open library, and two connecting student apartments. To ensure students' safety during their stay, the residences are staffed 24 hours a day by teachers, medical personnel and security guards.

珠海德威校园内配套了完备的教学、生活设施，为学校各学科的学习和实践活动提供优越的硬件加持，实现环境育人。校园基于人与自然和谐共生的理念，将自然元素由内到外融汇贯穿于整个校园。珠海德威校园还荣获LEED（《绿色建筑评估体系》）金奖认证。校园占地超19,600平方米，设有30个教室、14个科学实验室、四个户外运动场、一个室内体育馆、一个可同时容纳363人的剧院、开放式图书馆以及学生公寓。学生公寓独立运营和管理，配有24小时的生活老师、医护人员和安保人员，保障学生在校生活的安全。

Academic Performance and University Pathways

学术成就及升学路径

Dulwich Zhuhai graduates have been able to pursue their careers at the world's most prestigious universities, including Oxford University, Imperial College London, The London School of Economics and Political Science, University College London, Stanford University, New York University, University of Melbourne, University of Toronto, and University of Hong Kong, as well as worldrenowned art colleges such as the University of the Arts in London, Rhode Island School of Design and Berkeley Conservatory of Music.

Nearly a quarter of the students have been admitted into Top 10 QS ranked universities while 80% of them got into Top 100. They excel in fintech, biomedicine, chemical engineering, life sciences, economics, business, law, architecture, art, design and music.

办学十多年，珠海德威培养出一批批优秀的毕业生，助力他们通往人生理想的学府：牛津大学、帝国理工学院、伦敦政经学院、伦敦大学学院、斯坦福大学、纽约大学、墨尔本大学、多伦多大学、香港大学等综合性大学，以及伦敦艺术大学、罗德岛设计学院、伯克利音乐学院等知名艺术类院校。

近10年来，累计近1/4 学生升入全球QS排名前10的大学；近80%毕业生入读排名前100的大学。录取专业覆盖了金融科技、生命科学、生物医药、化学工程、经济商管、法学、建筑、艺术设计和音乐等领域。

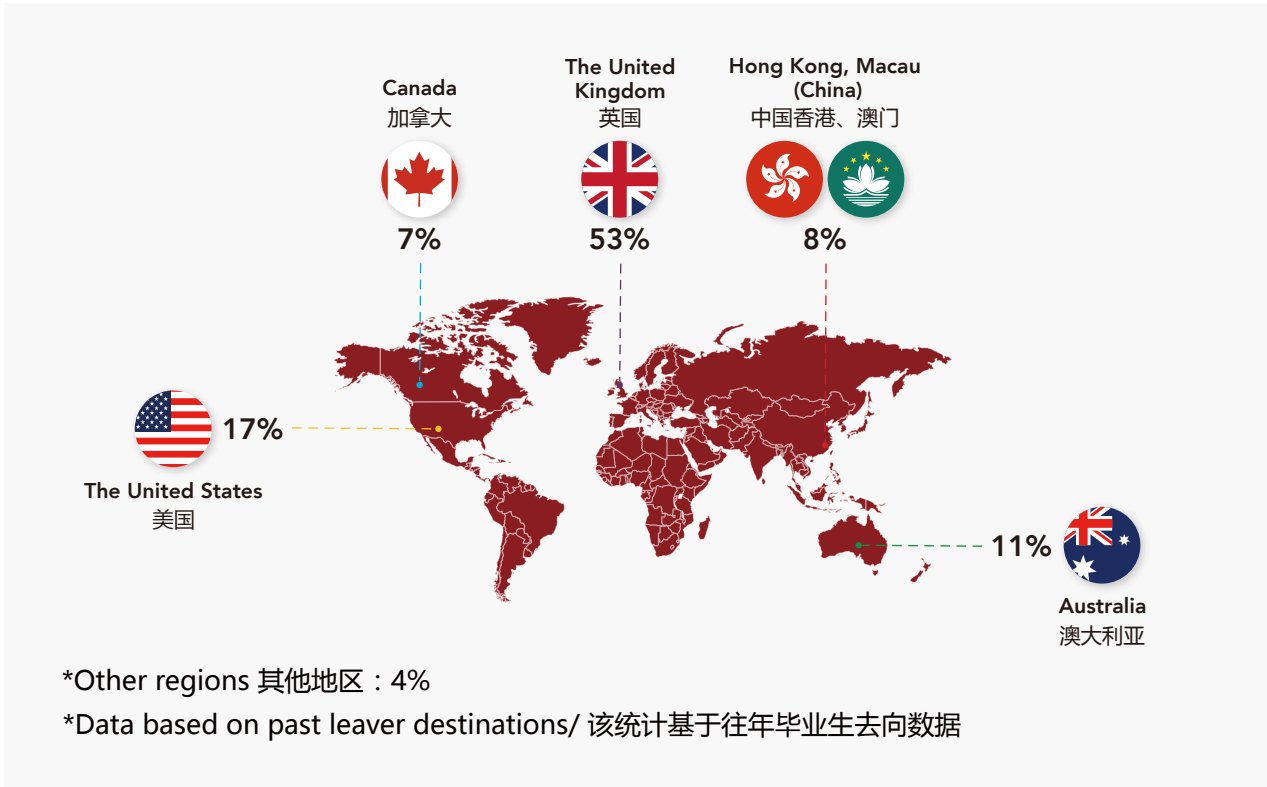

| | | | | | |
|-----------------------------------|--|---|--|---|---|
| G5 英国G5精英大学 |  University of Oxford 牛津大学 |  Imperial College London 帝国理工学院 |  University College London 伦敦大学学院 |  The London School of Economics and Political Science 伦敦政治经济学院 |  Durham University 杜伦大学 |
| North America 北美高校 |  Vanderbilt University 范德堡大学 |  Emory University 埃默里大学 |  University of California, Berkeley 加州大学伯克利分校 |  University of Toronto 多伦多大学 |  McGill University 麦吉尔大学 |
| STEM 科学、数学与工程 |  Carnegie Mellon University 卡内基梅隆大学 |  Virginia Tech 弗吉尼亚理工大学 |  Rice University 莱斯大学 |  Northeast University 东北大学 |  The Hong Kong University of Science and Technology 香港科技大学 |
| Economics and Management 经济与管理 |  University of Warwick 华威大学 |  The University of Manchester 曼彻斯特大学 |  University of Southern California 南加州大学 |  The University of Sydney 悉尼大学 |  The University of Hong Kong 香港大学 |
| Humanities 人文社科 |  New York University 纽约大学 |  University of California, Davis 加州大学戴维斯分校 |  The University of Edinburgh 爱丁堡大学 |  University of St Andrews 圣安德鲁斯大学 |  The Chinese University of Hong Kong 香港中文大学 |
| Art, Music and Design 艺术，音乐和设计 |  Royal College of Music 英国皇家音乐学院 |  Central Saint Martins 伦敦圣马丁 |  University of the Arts London 伦敦艺术大学 |  Berklee College of Music 伯克利音乐学院 |  Pratt College 普瑞特艺术学院 |

Academic Performance and University Pathways 学术成就及升学路径



The priority of the University and Career Counselling department (UCC) is to advocate for students, and further to advise students and parents on a case-by-case basis. UCC works with various disciplines to help students find the "Best Fit" route to further education. Through membership of the International Association of College Admissions Counsellors (IACAC) and China Institute of College Admission Counseling (ChinalCAC), we are developing highly useful personal relationships with admissions teams.

在珠海德威，升学指导部门老师的第一要务是为学生和家长提供“量身定制”的指导和支持。升学指导部门与各学科合作，帮助学生踏上“最佳匹配”的升学路径。我校也是美国大学申请指导海外联盟（IACAC）和中国升学指导协会（ChinalCAC）成员之一，每年会派出一名代表参加年会和论坛，与顶尖名校的招生团队建立有价值的良好沟通关系。



The Road Map to Best-Fit University

Y13

Receive university offers
UCC: Provides students and parents with one-to-one advice.

Y12

Research preferred universities and majors
UCC: Provides guidance on university application preparation, incl. improving CVs and writing essays

Y11

Start to have direction for future career and take IGCSE exams
UCC: Supports students in choosing AS subjects and provides clear information about applications

Y10

Adapt to international school life, identifying strengths and interests
UCC: weekly UCC lessons

最佳适配大学升学路径

13年级

完成大学申请，升读名校
升学指导：与学生和家长做一对一沟通和指导

12年级

对心仪大学和专业进行深入调研
升学指导：指导学生为大学申请做好全方位准备，包括学术、语言、活动，以及申请文书撰写

11年级

对未来的专业选择有明朗的方向，完成IGCSE大考
升学指导：指导学生完成AS选课，清晰介绍大学

10年级

适应高中生活，明确特长与兴趣，积极参与活动
升学指导：每周一次小班课程

Worldwise Alumni Networ (WAN)
全球校友资源平台

Dulwich is committed to being a bridge connecting students with the world. At Dulwich, every graduate remains a member of the Dulwich family. Through our Worldwise Alumni Network, the alumni can share resources, network with like-minded fellow graduates, and develop personally and professionally. We encourage and invite alumni to return to the schools and share their experiences of Dulwich school life and further education with current Dulwich students, helping them to find their best-fit.

德威致力于架设通往世界的桥梁。在德威，每位学子毕业后也依然是德威大家庭的成员。在这个覆盖世界各地的校友网络平台，德威校友能共享资源，与志同道合的伙伴结交，实现个人和专业的发展。我们鼓励和邀请校友重返校园，与德威的在校学生分享他们在学习以及选择专业和升学方面的经验，帮助他们找到最佳匹配的发展路径。



BRIDGES TO THE WORLD
架起通往世界的桥梁
BUILDING THE WORLD
建设世界

Admissions

入学申请

Our school is open to the students from 14–18 years old from around the world. We are looking for the “Best fit students, Best fit families” to join Dulwich Zhuhai.

■ Entry for SY 2024-2025

01 Enquiry

Browsing the official website or calling for consultation 0756-8693133, 189 2339 2863, 189 2336 1453.

02 Arrange Visits

Make an appointment for "School Visit" through WeChat official account.



School Visit

03 Formal Application

1. Fill the registration form and pay non-refundable admissions fee (600 RMB/per student).
2. Submit copy of last two- or three-year academic reports (affixed with the school official seal).
3. Submit Copy of applicant's ID / passport and home-vist permit (valid documentation).
4. Submit Other documents such as recommendation letters, certificates of personal's skill, language level and artworks.

04 Entrance Examination and Interviews (Saturdays)

Exam Dates: 2024/03/16, 2024/04/13, 2024/05/11, 2024/07/02 (Tue), 2024/07/06.
Exam Subjects: Online English, Math, Patterns/ Non-verbal assessments and 1-1 interview. It will take about 1 hours and 20 minutes.

05 Results

The result will be sent out within 1-2 working weeks after the assessment; cannot retake if been rejected.

06 Enrollment

Tuition fees; according to the fee payment method you select either online banking or CCB APP system. Please ensure to remit the tuition fees to the school account before the deadline to secure the place and see more details of payment items on our school website or leaflet will be provided.

Bank Account Name: 珠海市华德教育培训有限公司

Bank Account Number: 9550880223707900113

Bank: 广发银行珠海三台支行

The parents should bring copies of the following documents and sign the School Attendance Agreement by deadline.

- Copy of achievements of National High School Entrance Examination (Zhongkao) if any.
- Copy of parent's / guardians ID / passport and home-vist permit (valid documentation)

德威珠海招收14-18周岁的中外籍及港澳台地区学生，共同寻求“最适合”的教育。

■ 2024年9月入学

01 查询

浏览官网或致电咨询 0756-8693133、189 2339 2863、189 2336 1453。

02 参观访校

通过微信公众号预约“参观访校”



参观访校

03 线上注册报名

1. 填写申请表并缴纳考试费用（600元/每人，不退还）。
2. 提交最近两年或三年在校成绩（需要学校公章）。
3. 提交申请人身份证或护照或港澳台有效身份证复印件。
4. 提交其他辅助资料，如各类特长证书，个人作品或者视频，语言水平证书和学校推荐信等。

04 入学考试与面试（周六）

可考试日期：2024/03/16、2024/04/13、2024/05/11、2024/07/02（周二）、2024/07/06。
考试科目：英文、数学、图形逻辑和一对一面试；前3项为机考选择题；全程1小时20分钟。

05 录取

考试结束后1-2个工作周公布录取结果，不可重考。

06 入学流程

缴纳学费；根据所选择的就读方式确认相应学费。为确保入学名额并在指定日期内将学费汇款至学校账户或使用建设银行APP系统。

户名：珠海市华德教育培训有限公司

帐号：9550880223707900113

开户行：广发银行珠海三台支行

请家长准备以下相关资料到校签订《就学协议书》，按照学校指定日期签署，完成入学手续。

- 中考成绩证明（在收到中考成绩后提交）
- 父母 / 监护人有效身份证复印件或港澳台回乡证复印件

School Site and Map

校址及地图



29 Hongjing Road, Hengqin New District,
Zhuhai, Guangdong, China 519031
中国广东省横琴粤澳深度合作区红景道29号
邮编：519031
座机/手机: 86-756-8693233 / 18923392863, 18923361453

Transportation Information

1. 1 hour ferry from Hong Kong / Shenzhen to Zhuhai Jiuzhou Port, 30 min drive from Jiuzhou Port to school
2. 1.5 hour ferry from Shenzhen to Zhuhai Hengqin Port, 15 min drive from Hengqin Port to school

交通信息

1. 从香港/深圳搭船至珠海九洲港航程1小时，九州港到学校车程约半小时
2. 从深圳搭船至珠海横琴码头航程1.5小时，横琴码头到学校车程约15分钟